

## Capital Improvement Project Request Form

Department/Organization: Administration Date: July 11, 2002Capital Improvement Project Committee Project Number: 29

Capital Improvement Project Committee Score/Rank: \_\_\_\_\_

### PROJECT DESCRIPTION

1. Project Title: Sawmill Drive Extension
2. Location: Sawmill Drive, Richardson Business Park/Airport Industrial Park
3. Description (Scope of Work, including quantities): Extend Sawmill Drive approximately 1000 ft. to connect at intersection of Atigun Drive and Salcha Way.
4. Purpose: The majority of the right-of-way was cleared and grubbed to accommodate the installation of the 12-inch water line as part of the Mineral Creek Water Improvements Project. By extending the driving surface to Salcha Way and Atigun Drive it would provide an alternate access to and from the two Mobile Home Parks in that area as well as the other lots recently made accessible in the Airport Industrial Park (end of Atigun Drive). The City will continue to block access from the cul-de-sac end of Sawmill Drive and Valdez Mobile Home Park until the driving surface is brought up to those standards identified in Valdez City Code.
5. Justification: Since this access has been opened there is already a fairly steady flow of traffic through this area. Traffic flows will only continue to increase. Unless the City substantially blocks this access it will be utilized even though it is not an approved road with an acceptable driving surface.

**GOAL CONTRIBUTION** - Capital improvement proposals that would help achieve the City's goals and the policies of The City of Valdez Comprehensive Plan, meet program objectives and ensure maintenance of the City's infrastructure systems, and an equitable delivery of municipal services, may be evaluated for their general goal/program contributions.

1. How would this project help achieve any of the City's eight goals and the policies of The City of Valdez Comprehensive Plan? This project would provide an alternate access for two Mobile Home Parks in the area as well as the Airport Industrial Park Subdivision. It could also increase the value of frontage property along Sawmill Drive that currently just dead-ends at a cul-de-sac.
2. Where/How does this project fit into your departments/organizations 5-year plan? This project was proposed for the 2002 CIP Budget but the City Council opted not to fund it because it would not access any new City owned property.
3. If this project were not funded this year how would it effect the operation of your department/organization? The Public Works Department may have some small expenses in maintain the gravel berm placed at each end blocking access through the area.

**PRIORITIES** - Capital improvement proposals that can be identified with specific priorities in the Priorities Process and the City of Valdez Comprehensive Plan are to be recognized for their potential value to those priorities.

1. Level of Need. Proposals may be evaluated as either *essential*, *important* or *desirable* for the delivery of required City services. Desirable
  - a. why? I don't believe that it is a project that must be done or would have any major impact if it were not constructed.
2. Multi-year Project. Is this the second or subsequent year of a previously approved project; an integral part of a multi-year project or an inseparable part of a larger improvement; and completion of the whole project would be jeopardized if the project is not funded? NO
  - b. why?

**QUANTITATIVE CRITERIA** - Provides for the evaluation of capital improvement projects in terms of 5 quantitative measures.

1. Should a point be given for Employee Safety? Include copies of specific codes to be addressed and/or specific documented events and how they will be corrected by the proposed project. NO.
2. Should a point be given for Facility Maintenance or Improvements? Include documentation of escalating repair/minor maintenance costs and/or substantiate that equipment/device has reached it expected life span. NO
3. Should a point be given for the Leveraging of City Funds? Provide documentation of existing Grant(s) and identify all local match requirements, provide documentation of proposed grant(s) and indicate how it would affect the project if we were not awarded the grant. NO.
4. Should a point be given for Reducing a City Expense Line Item? Provide documentation of proposed cost savings and/or timeline in which project will pay for itself as a result of increased efficiencies and/or reduced annual maintenance costs. NO.
5. Should a point be given for Increasing a City Revenue Line Item? Provide documentation of anticipated revenues. NO.

**QUALITATIVE CRITERIA** - Provides for the evaluation of capital improvement projects in terms of 2 qualitative measures.

1. Should a point be given for Public Benefit and why? YES. It would provide an alternate access to two Mobile Home Parks in the area as well as the Airport Industrial Park Subdivision. It could also increase the value of frontage property along Sawmill Drive that currently just dead-ends at a cul-de-sac.
2. Should a point be given for Future Planning Capabilities? NO.

**CAPITAL COST**

Estimated Design cost \$11,000.00 estimated by CRW Engineering  
Estimated Construction cost \$85,000 (gravel) estimated by CRW Engineering  
Additional \$65,000 to pave entire length of Sawmill (Highway to new intersection)

**OPERATING COST**

Estimated Annual Operating cost \$0 estimated by \_\_\_\_\_  
Estimated Annual Maintenance cost \$3500 estimated by Engineering/Street

**TOTAL COST** \$96,000 (gravel) or \$161,000 (paved)  
Anticipated lifetime of the project 20 years

**PRIORITY**

- A. What priority number does your department/organization assign to this project among those being requested at this time? 3
- B. What are your reasons for attaching this priority rating to this project? Hospital and School project funding are our top priorities.

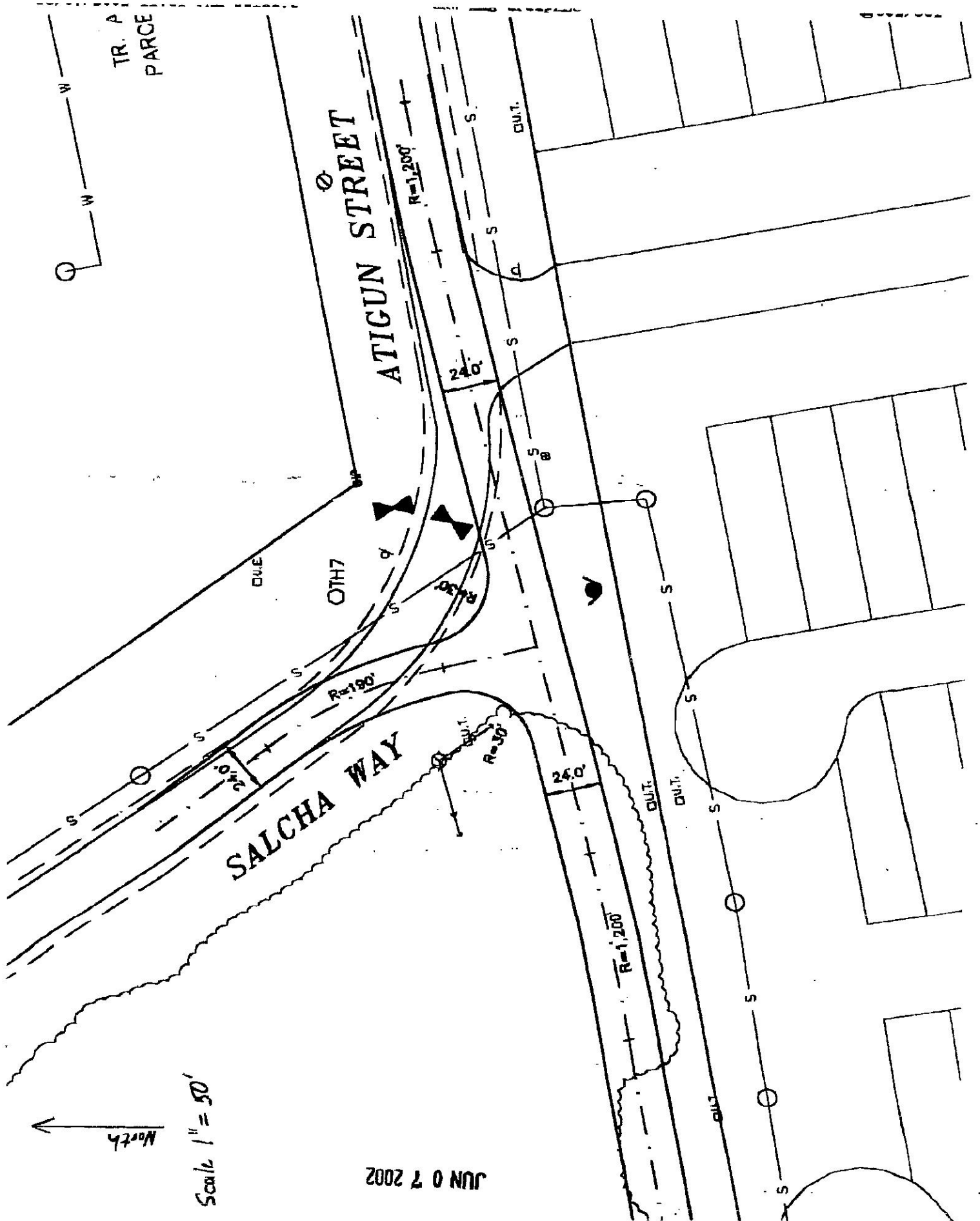

We the undersigned residents and neighbors of Valdez Mobile Home Park are petitioning the City of Valdez to have Sawmill Road extended approximately 1000 ft. to connect at intersection of Atigun Drive and Salcha Way by the Fall of 2004.

This extension would give the residents of Valdez Mobile Home Park, Glacier View Mobile Home Park as well as residents of the Airport Industrial Park an additional access to Richardson Highway should there be a blockage on either Airport Road or Salcha Way. It will also allow residents and their children a safe access to reach the bike-path without having to obstruct traffic on Salcha Way.

We understand that the project is not budgeted for 2003, however, we want it to be budgeted by Fall of 2004. We are not asking for the extension to be paved just to be brought up to code as Sawmill Drive Extension project has been proposed for the last 2 CIP Budget years but the City Council has not seen fit to fund this project.

We also petition that the current dirt blockage to be removed until the upgrade is possible, allowing an immediate and safe access.

Name	Signature	Box #	Date
Dorinda Waller	Dorinda Waller	508	5/20/03
RAY RICHARDS	Ray Richards	3643	5/23/03
DICK DORE	DICK DORE	2147	5/23/03
Edward Jones	Edward Jones	933	5-23-03
Tom Morgan	Tom Morgan	3722	5-26-03
Michael Curtis	Michael Curtis	1534	5-26-03
Michael Waller	Michael Waller	508	5-26-03
Patrick Morgan	Patrick Morgan	3722	5/26/03
Janet L. Morgan	JANET L. Morgan	3722	7/26/03
Rayann Dancer	Rayann Dancer	3028	5/26/03
Gary Wattengel	Gary Wattengel	3074	5-26-03
John Dargatzis	John Dargatzis	3512	5/27/03
ELIZABETH WILLIAMS	Elizabeth Williams	1277	5/27/03
Jennifer Chaffin	Jennifer Chaffin	547	5/27/03
BONNIE	BONNIE	508	5/27/03
Gary A. Kimball	Gary A. Kimball	1493	5-27-03
Brandon Kilian	Brandon Kilian	1767	5-28-03
Michael Rosenmund	Michael Rosenmund	1529	5-29-03
Laurie Price	Laurie Price	367	5-29-03
DANA L. MCCAIN	DANA L. MCCAIN	566	5/30/03

We the undersigned residents and neighbors of Valdez Mobile Home Park are petitioning the City of Valdez to have Sawmill Road extended approximately 1000 ft. to connect at intersection of Atigun Drive and Salcha Way by the Fall of 2004.

This extension would give the residents of Valdez Mobile Home Park, Glacier View Mobile Home Park as well as residents of the Airport Industrial Park an additional access to Richardson Highway should there be a blockage on either Airport Road or Salcha Way. It will also allow residents and their children a safe access to reach the bike-path without having to obstruct traffic on Salcha Way.

We understand that the project is not budgeted for 2003, however; we want it to be budgeted by Fall of 2004. We are not asking for the extension to be paved just to be brought up to code as Sawmill Drive Extension project has been proposed for the last 2 CIP Budget years but the City Council has not seen fit to fund this project.

We also petition that the current dirt blockage to be removed until the upgrade is possible, allowing an immediate and safe access.

Name	Signature	Box #	Date
Louise Anderson	Louise Anderson	Box 2180	5/30
Wendy Clubb	Wendy Kauf Clubb	Box 3507	5/30/03
Kyle Hughes	Kyle Hughes	Box 1448	5/30/03
Dede Gibson	Dede Gibson	Box 2021	5/30/03
Karen Hase	Karen Hase	Box 2021	5/30/03
Norman Rogers	Norman Rogers	Box 1448	5/30/03
Miranda Kompoff	Miranda Kompoff	Box 2714	5-30-03
Delaney Brown	Delaney Brown	Box 2714	5-30-03
Cory Stambach	Cory Stambach	Box 1290	5-30-03
Cristy Lutz	Cristy Lutz	Box 3665	5/30/03
Kurt Mickelson	Kurt Mickelson	Box 3726	5/30/03
Sam Hannon	Sam Hannon	Box 142	5/30/03
OLY Clubb	OLY Clubb	Box 3507	5/30-03
Kathleen Katschinski	Kathleen Katschinski	2693	05/30/03
Don Kompoff Jr	Don Kompoff Jr	494	05/30/03
Colette Labonte	Colette Labonte	3202	5-30-03
Mike Tucker	Mike Tucker	Box 1880	5-31-03
Steve Metcalf	Steve Metcalf	Box 1958	5-31-03
JFF Jensen	JFF Jensen	1396	5-31-03
DARCY ROSSBORO	Darcy Rossboro	Box 1066	5-31-03
Daniel L. Nichols	Daniel L. Nichols	Box 831	5-31-03
Tippie Higgins	Tippie Higgins	Box 2137	5-31-03
		Box 35	5-31-03

OVER



[illegible]

We the undersigned residents and neighbors of Valdez Mobile Home Park are petitioning the City of Valdez to have Sawmill Road extended approximately 1000 ft. to connect at intersection of Atigun Drive and Salcha Way by the Fall of 2004.

This extension would give the residents of Valdez Mobile Home Park, Glacier View Mobile Home Park as well as residents of the Airport Industrial Park an additional access to Richardson Highway should there be a blockage on either Airport Road or Salcha Way. It will also allow residents and their children a safe access to reach the bike-path without having to obstruct traffic on Salcha Way.

We understand that the project is not budgeted for 2003, however; we want it to be budgeted by Fall of 2004. We are not asking for the extension to be paved just to be brought up to code as Sawmill Drive Extension project has been proposed for the last 2 CIP Budget years but the City Council has not seen fit to fund this project .

We also petition that the current dirt blockage to be removed until the upgrade is possible, allowing an immediate and safe access.

[illegible]



We the undersigned residents and neighbors of Valdez Mobile Home Park are petitioning the City of Valdez to have Sawmill Road extended approximately 1000 ft. to connect at intersection of Atigun Drive and Salcha Way by the Fall of 2004.

This extension would give the residents of Valdez Mobile Home Park, Glacier View Mobile Home Park as well as residents of the Airport Industrial Park an additional access to Richardson Highway should there be a blockage on either Airport Road or Salcha Way. It will also allow residents and their children a safe access to reach the bike-path without having to obstruct traffic on Salcha Way.

We understand that the project is not budgeted for 2003, however; we want it to be budgeted by Fall of 2004. We are not asking for the extension to be paved just to be brought up to code as Sawmill Drive Extension project has been proposed for the last 2 CIP Budget years but the City Council has not seen fit to fund this project.

We also petition that the current dirt blockage to be removed until the upgrade is possible, allowing an immediate and safe access.

Name	Signature	Box #	Date
Louis Vlasoff	Louis Vlasoff	3726	5-30-03
Kolvin Kampkoff	Kolvin Kampkoff	522	5-30-03
Shawn Barnes	Shawn Barnes	3726	5-30-03
Richard O. Roseberry	Richard O. Roseberry	2784	5/30/03
PATRICK O. DONNELL	Patrick O. Donnell	2838	5/31/03
John Gillingham	John Gillingham	3482	5/31/03
Michael Komptoff	Michael Komptoff	3737	6/1/03
Tom HALE	Tom HALE	2720	6/2/03
Ennalie Logsdon	Ennalie Logsdon	3026	6/2/03
Mike Burzinski	Mike Burzinski	3504	6-2-03
Billy RUTHERFORD	Billy Rutherford	1085	6-2-03
Douglas Cranor	Douglas K. Cranor	1164	6-2-03
Tim MOELLER	Tim Moeller	1362	6-2-03
Larinda Totemoff	Larinda Totemoff	3211	6-2-03
Ernest Elbbert	Ernest Elbbert	2383	6-2-03

We the undersigned residents and neighbors of Valdez Mobile Home Park are petitioning the City of Valdez to have Sawmill Road extended approximately 1000 ft. to connect at intersection of Atigun Drive and Salcha Way by the Fall of 2004.

This extension would give the residents of Valdez Mobile Home Park, Glacier View Mobile Home Park as well as residents of the Airport Industrial Park an additional access to Richardson Highway should there be a blockage on either Airport Road or Salcha Way. It will also allow residents and their children a safe access to reach the bike-path without having to obstruct traffic on Salcha Way.

We understand that the project is not budgeted for 2003, however; we want it to be budgeted by Fall of 2004. We are not asking for the extension to be paved just to be brought up to code as Sawmill Drive Extension project has been proposed for the last 2 CIP Budget years but the City Council has not seen fit to fund this project .

We also petition that the current dirt blockage to be removed until the upgrade is possible, allowing an immediate and safe access.

[illegible]

Josh Gonka	<i>for Jan</i>	Box 896	5-31-03
JEFF V. HOBKINS	<i>Jeff W. Hopkins</i>	BOX 352	5-31-03
JASON STANTON	<i>Jason Stanton</i>	BOX 665	5-31-2003
STEVE ALLEY <sup>SN.</sup>	<i>Stu Alley</i> <sup>SN.</sup>	Box 921	5-21-03
Rusty Hood	<i>RH</i>	Box 1086	5-31-03
Ester Bermudez		Box 3123	5-31-03
Bill Harris	<i>Bill Harris</i>	Box-6	5/31/03
Ed James	<i>Ed James</i>	Box 154 Tok Ak	5-31-03
Debra James	<i>Debra James</i>	Box 154 TDIC	5-31-03
<i>Adrian Collier</i>		Box 982	5-31-03
Tommy Bost		Box 3412	5-31-03
James Crawford		Box 3408	5-31-03
Lana Smith		Box 92	5-31-03
Tim Adams		Box 2563	5-31-03
Shane Stewart		Box 554	5-31-03
Brandon Kilian	<i>B-K</i>	Box 1767	5-31-03
Harry Wood		Box 1284	5-31-03
<i>Rob Appelhaus</i>		Box 2802	6-1-03
TONY IMPERIAL	<i>Tony Imperial</i>	Box 2087	6-1-03
Cindy Heston		POB 3427	6-1-03
<i>Tim M. Schmit</i>		PO 241	6-1-03
<i>Steph Buch</i>		Box 2374	6-1-03
<i>Bob Buch</i>		Box 3112	6-1-03
<i>Alon Kiser</i> - A.J. Kiser		Box 3646	6-1-03
Michael Hines		Box 2583	6-1-03
<i>Conrad McCullister</i>		Box 9813	6-1-03
<i>Ken Bost</i>		Box 2258	6-1-03
<i>Tom Bost</i>		Box 3583	6-1-03