

# Subsurface mineral rights

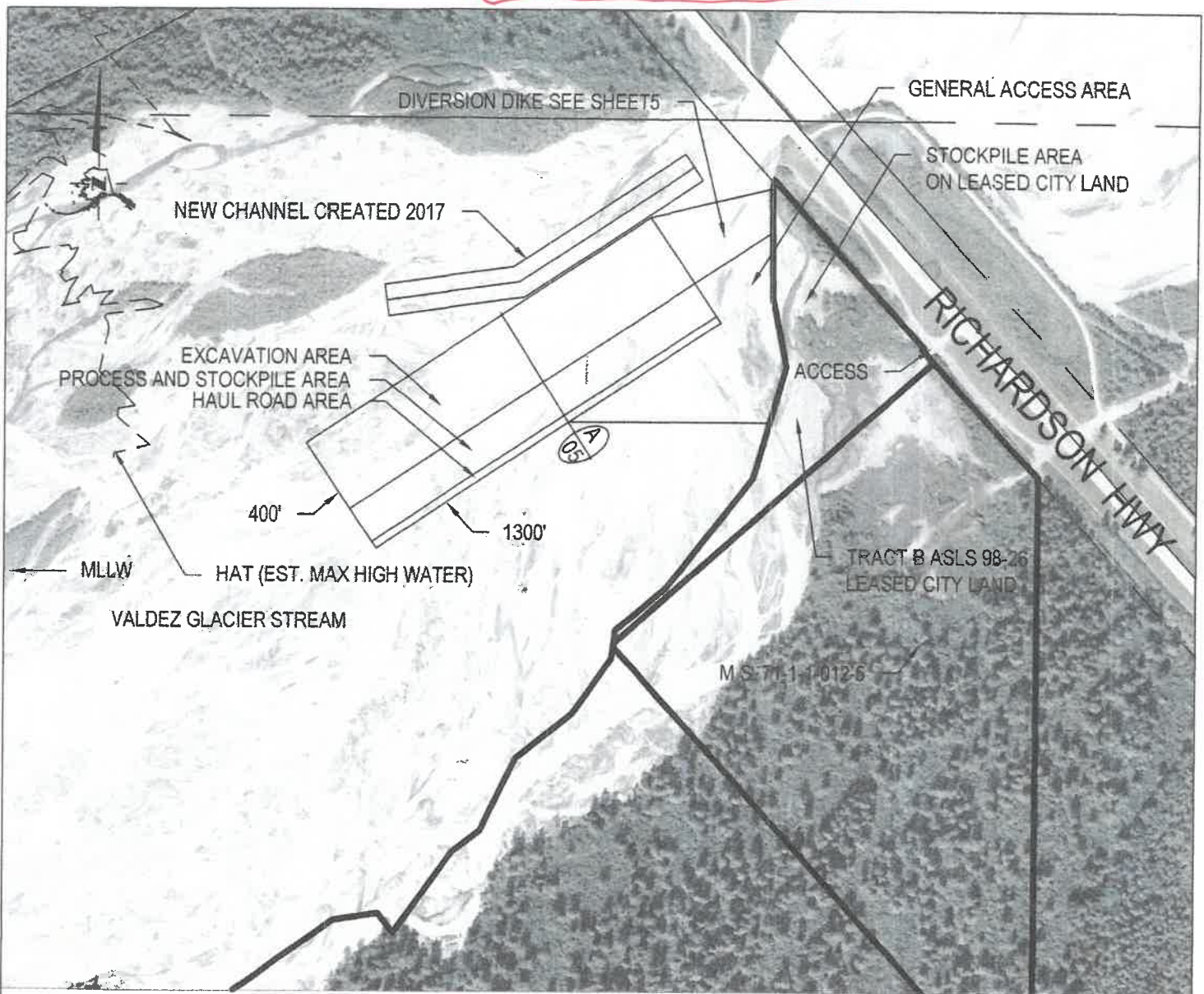

## PROPOSED CONSTRUCTION PLAN

1" = 500 FEET

(A) CROSS SECTION #

(05) CROSS SECTION SHEET #

VALDEZ GLACIER STREAM IMPACT AREA: 764,225 SF (17.54 ACRES)  
CITY OF VALDEZ TRACT B AREA: 297,079 SF (6.82 ACRES)  
TOTAL IMPACT AREA: 1,061,304 SF (24.36 ACRES)

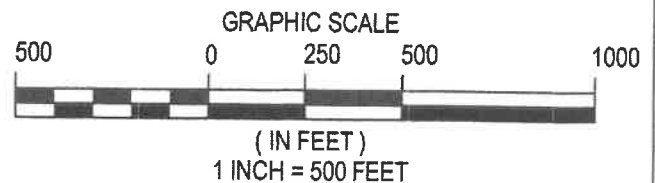

CITY: VALDEZ BOROUGH: N/A STATE: ALASKA  
DIRECTIONS: FROM INTERSECTION OF AIRPORT ROAD  
AND RICHARDSON HIGHWAY APPROXIMATELY 3.6  
MILES FROM NEW VALDEZ POST OFFICE. GO EAST ON  
RICHARDSON HIGHWAY 1.8 MILES JUST PASS THE  
VALDEZ GLACIER STREAM BRIDGE (SOUTH) SIDE OF  
THE ROAD.

APPLICANT: MEGA TRUCKING L.L.C.  
FILE NO.: POA-  
WATERWAY: VALDEZ GLACIER STREAM  
PROPOSED ACTIVITY: GRAVEL EXTRACTION  
SEC. 11, T. 9 S., R. 6 W., COPPER RIVER MERIDIAN  
LAT.: N 61°06'27" LONG.: W 146°14'02" NAD 83  
SHEET 4 OF 6 DATE: 6/6/17